

1:500

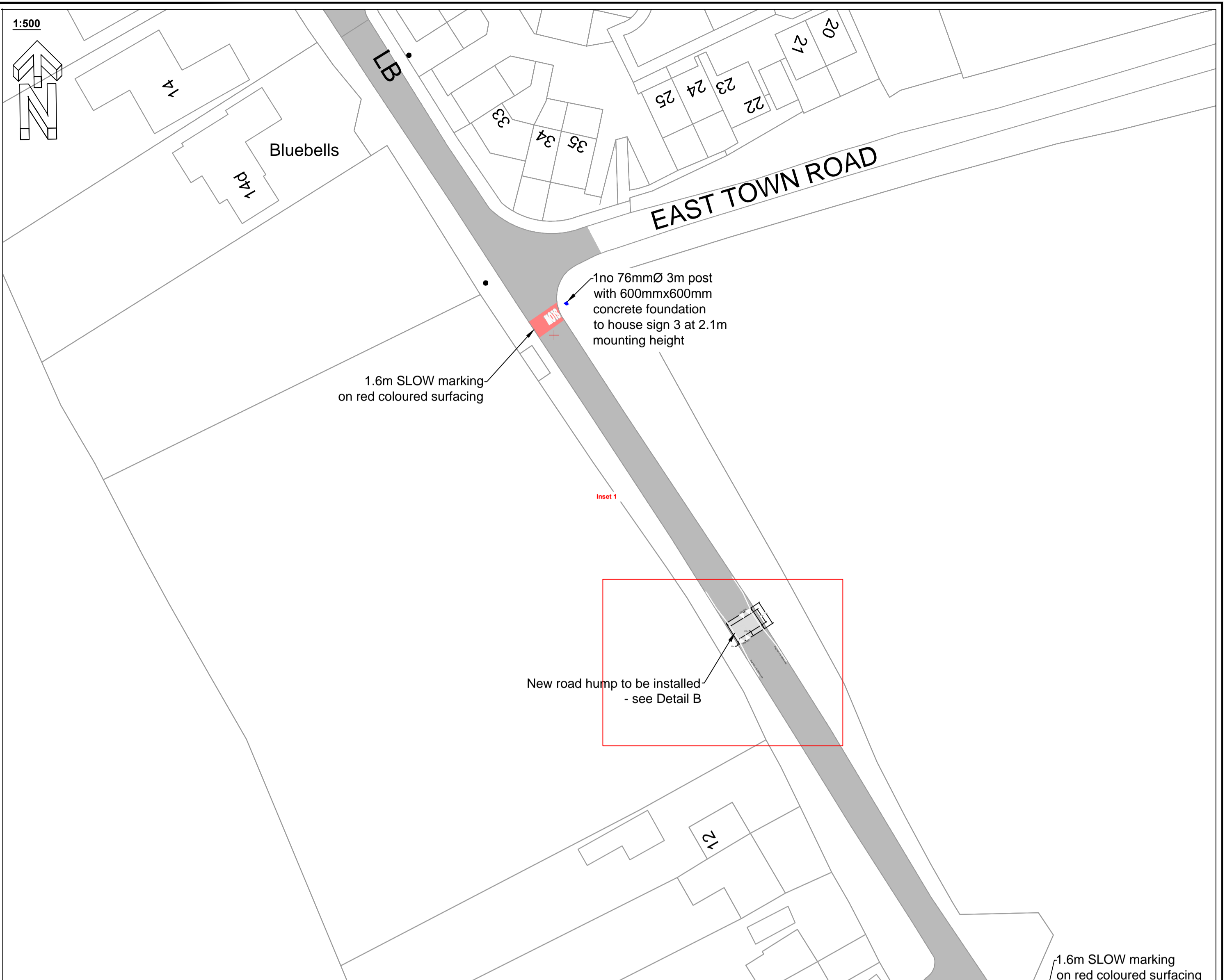
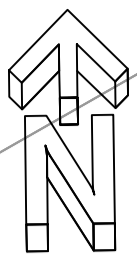

1.6m SLOW marking
on red coloured surfacing

1 no 76mmØ 3m post
with 600mmx600mm
concrete foundation
to house sign 3 at 2.1m
mounting height

New road hump to be installed
- see Detail B

1.6m SLOW marking
on red coloured surfacing

1 no 76mmØ 3m post
with 600mmx600mm
concrete foundation
to house sign 4 at 2.1m
mounting height

Inset 1 1:100
See Detail B for construction information



Refer to 5159428-300-ATK-D-001-C1 for
ducting information

Key		General Notes	
	3m 76mm Ø galvanised steel post with 600mmx600mm concrete foundation and sign as specified	<p>1. The works shown on this drawing could affect statutory undertakers apparatus and the contractor is required to verify the location and depth of all such apparatus prior to the commencement of works and to take all precautions necessary when working in the vicinity of such apparatus. Utility information is produced from a digital source and no guarantee can be given regarding its accuracy. It is the recipients responsibility to check accuracy of measurements given. Should discrepancy occur please contact issuing authority to seek clarification.</p> <p>2. The use of this drawing does not absolve the client from his responsibilities under Health & Safety: The Construction (Design and Management) Regulations 2015.</p> <p>3. All Road markings shall be laid in accordance with The Traffic Signs Manual Chapter 5: All road marking material shall be formed in thermoplastic material complying with BS 3262: Class A.</p>	
	High Friction Surfacing C1924 Type 1 Cold Applied MMA resin - Red		
	High Friction Surfacing C1924 Type 1 Cold Applied MMA resin - Buff		
	Excavation - 200mm clearance around cushions. 40mm surface course to be planed off and reinstated upon completion		

<p>Traffic & Network Management County Hall, Bythesea Road, Trowbridge Wiltshire, BA14 8JD Tel: 0300 4560100 Website: www.wiltshire.gov.uk</p>		<p>PROJECT: TROWBRIDGE COMMUNITY AREA TRANSPORT GROUP BRATTON ROAD WEST ASHTON TRAFFIC CALMING</p>																																																	
<p>This map is reproduced from Ordnance Survey material with the permission of Ordnance Survey on behalf of the Controller of Her Majesty's Stationary Office © Crown copyright. Unauthorised reproduction infringes Crown Copyright and may lead to prosecution or Civil Proceedings. Wiltshire Council (100049050) 2012</p>		<p>DRAWING TITLE: SHEET 3 OF 4 DETAIL DESIGN</p>																																																	
<table border="1"> <tr> <td>F</td><td></td><td></td><td></td><td></td><td></td> </tr> <tr> <td>E</td><td></td><td></td><td></td><td></td><td></td> </tr> <tr> <td>D</td><td></td><td></td><td></td><td></td><td></td> </tr> <tr> <td>C</td><td></td><td></td><td></td><td></td><td></td> </tr> <tr> <td>B</td><td></td><td></td><td></td><td></td><td></td> </tr> <tr> <td>A</td><td></td><td></td><td></td><td></td><td></td> </tr> <tr> <td>O</td><td>08/17</td><td>KR</td><td>DMT</td><td>DMT</td><td>ORIGINAL</td> </tr> <tr> <td>REV</td><td>DATE</td><td>DRAWN</td><td>CHECK</td><td>APPRV</td><td>DESCRIPTION</td> </tr> </table>		F						E						D						C						B						A						O	08/17	KR	DMT	DMT	ORIGINAL	REV	DATE	DRAWN	CHECK	APPRV	DESCRIPTION	<p>DRAWING PURPOSE: FINAL</p>	
F																																																			
E																																																			
D																																																			
C																																																			
B																																																			
A																																																			
O	08/17	KR	DMT	DMT	ORIGINAL																																														
REV	DATE	DRAWN	CHECK	APPRV	DESCRIPTION																																														
<p>SCALES: AS SHOWN</p>		<p>SHEET SIZE: A2</p>																																																	
<p>DRAWING No: 2015-102-D-001 3/4</p>		<p>REVISION: 0</p>																																																	
<p>FILE REF:</p>																																																			